

**OREGON PUBLIC LAND CORNER REPORT / RESTORATION REPORT**  
Tillamook County Surveyor's Office

**BOOK 8 242**

<b>SECTION:</b> 21 AND 22	<b>TOWNSHIP:</b> 4 South	<b>RANGE:</b> 10 West
<b>COUNTY:</b> Tillamook		<b>DATE:</b> 2/25/2026
<b>CORNER DESIGNATION:</b>  Quarter corner common to sections 21 and 22, Township 4 South, Range 10 West, Willamette Meridian.		<b>(Please check one)</b>
		<input checked="" type="checkbox"/> Condition Report Only
		<input type="checkbox"/> Restoration
		<input type="checkbox"/> Rewitness
		<input type="checkbox"/> Unrecorded
		<input type="checkbox"/> Reset at surface
<input type="checkbox"/> Referenced Out		

**Previous Rewitnesses, Restorations and Surveys, etc...**  
BLM field note volume: OR-R0180 Page 0175.00 (1879), F-40-59 (1913), Rewitness Bk. 6, Pg. 169 (1967), A-1440 (1967), Rewitness Card #769 (1976), P-222 (1994), B-3116 (2007), B-3165 (2007), B-4037 (2020)

**History, condition, and sources**  
1879 (BLM field notes) set alder post for Quarter corner and established 2 bearing trees. 1967 (Rewitness Bk. 6 Pg. 169, A-1440) Original corner was searched for but not found corner was reestablished using calls from map A-205 and a 1 1/2" iron pipe was set for the Quarter corner and 2 accessories were established. 1976 (Rewitness Card #769) a 2" iron pipe with a 3" brass cap marked "1/4 S21 S22 RS 287 1976" was set in position of found 1 1/2" iron pipe and 1 new accessory was established. 2026 a 3" Tillamook County brass cap in concrete marked as shown hereon was found in good condition. Found accessories are listed below.

- Found:** 25" dia. twin maple N74 1/2°W 48.90' with healed scar and white do not cut tag and a yellow metal location tag (Rewitness Bk. 6, Pg. 169 8" dia. twin maple N74 1/2°W 48.90' with scribing) (Rewitness Card #769 24" twin maple N70°W 49.15') (1999 Rewitness Card #769 29" dia. twin maple N70°W 49.15')
- Found:** SW corner of garage foundation N40 1/2°E 75.0' (Rewitness Bk. 6, Pg. 169 SW corner garage foundation N40 1/2°E 75.0') (Rewitness Card #769 SW corner of garage foundation N40 1/2°E 75.0')
- Found:** Hat section post with yellow metal location tag North 0.8' (Rewitness Card #769 84" hat section post North 1.0')
- Found:** Power pole # 221500 N12°E 76.82' same pole number different pole (Rewitness Card #769 1999 power pole #221500 N16°E 72.02' nail with washer inside of scribed triangle)

**New accessories set:**  
  
The Monument was tied directly using GPS control in Oregon North Zone NAD 83/91 grid coordinates in US Survey feet. Coordinates provided hereon are given in WGS 84 Latitude and Longitude.

Latitude: 45°12'34.80208"  
Longitude: -123°54'18.96903"

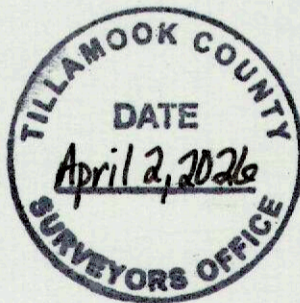

**Pictures of Found Monuments:**



**Location:** ±7' East of the East edge of Cloverdale-Woods Rd. ±1.5 miles west of Cloverdale.

**Tillamook County Surveyor office:** 1510 3<sup>rd</sup> Street Suite C, Tillamook, OR. 97141

**Party Chief:** Travis Porter, Tillamook County Survey Technician III

**Witnesses:** Michael Rice PLS 86926, Tillamook County Surveyor  
Kael Poklikuha, Tillamook County Survey Technician II

**Notes:** Digital images taken of monument and accessories.

**SURVEYOR'S SEAL**

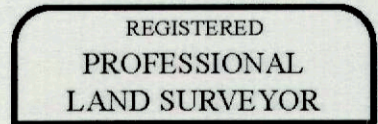

*Michael Rice*

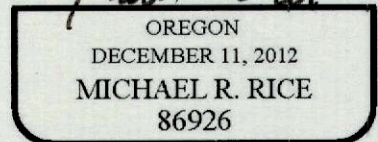

RENEWAL 12-31-2026